

From Antoinette Hall, General Manager, Eureka Tower

Dear Residents, Owners and Agents. Here we are the beginning of December 2020. The year has flown. Never did we think the COVID-19 situation would last so long and be so demanding on all of us Victorians. Its been a challenging year not only on our relationships and social life, but in interpreting DHHS and Victorian Government guidelines—which has not been easy.

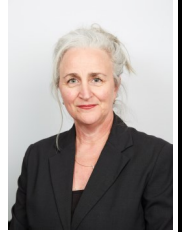

We are almost at the end of it and I thank all our residents who played their part to ensure Eureka Tower has been a COVID-19 safe haven. We also thank Real Estate Agents and contractors, who were cooperative in dealing with this pandemic and ensuring they followed the stipulated requirements. We will continue to update you all on any new steps we can take to move forward with this issue. Stay Well.

EASING OF RESTRICTIONS

- The gym, pool and cinema are open as long as these areas are booked in advance, face masks are worn if and when you can, and social distance of 1.5m is practiced.
- The sauna is open with social distancing required.
- If you are required to self-isolate, please advise Concierge immediately and self-isolate. We will assist you anyway we can.
- All contractors and real estate agents to the site must have a COVID Safe Plan, do a temperature check and sign in. We require this information for contact tracing.
- Please advise our Loading Dock in advance if a contractor is coming to the site. Contractors should not be let up through the car park until they have registered their details with the loading dock first.
- Up to 15 people can visit you at home each day.

CHRISTMAS TREE

Christmas will be a little different this year. A Christmas tree will still go up in the foyer on 1/12/2020. Unfortunately little helpers cannot attend to assist this year, but we hope to have them all ready and available for next year.



SALVATION ARMY CHRISTMAS

Its been a very tough year for so many people. The Salvation Army Christmas boxes will be out this year. We hope you are able to give generously. Lets fill up as many boxes as possible with non-perishable and within date food items as well as toys for all ages. There is no need to wrap the toys. Just purchase and pop them in the box at the front of the Concierge desk.

We thank you for your kind donations.

Pool Renovation and Disabled Pool Lift

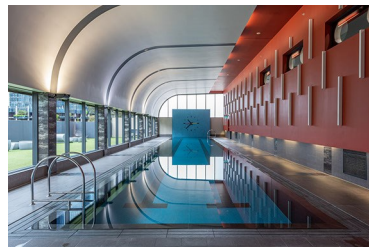

The pool renovation looks great and is open.

A disability pool lift is also about to be installed.

Anyone in a wheelchair or who requires assistance to

get in and out of the pool, will be able to do so easily, independently and in a very dignified manner.

Once the pool pod is installed, we will advise all residents. An induction will be required on its use and we will arrange this for those who require it. Once inducted, a designated fob will be required for its operation.

It is an amazing piece of equipment which provides all residents the opportunity to enjoy the pool facility.



Yoga



Eureka Tower weekly yoga classes have been via Zoom this year however we are keen to resume on L52 in 2021. Interested in attending? Please complete the short survey to indicate your preferences. Survey closes on 22/12/2020. <https://www.surveymonkey.com/r/R96KCRR>

GENERAL

Eureka 89 at Home

EUREKA 89

Eureka 89 is excited to open for dining again from Thursdays to Sundays with new summer & 3 course lunch menus launching in December. Due to popular demand their **Heat at Home** meals with an updated menu consisting of the most popular dishes from the past months will also be available. To book, order or find out more visit:

eureka89.com.au or
<https://eureka89.com.au/takeaway-order-form/>

Gym/Pool Inductions

Lesley Maxwell
FITNESS

Gym/Pool Inductions must be booked via Concierge before access to these facilities is provided. Inductions are held with Lesley Maxwell who can also organize personal training sessions or programs designed to meet your specific goals:

You can contact Lesley directly on 0419 822 882 or email me at lesley@lesleymaxwell.fitness. With over 10 years personal training experience, an author plus world figure champion she could be just what you need to get yourself back into shape.

Eureka Tower Car Park Towing

Eureka Tower now has towing arrangements in place. Please contact Concierge for any illegal parked vehicles so we can check. Towed vehicles will be towed at the vehicle owner's expense.



Noise & Trash from your balcony

As we head out of lockdown and into summer, there will be a lot more socializing going on. When you do so, please respect those around you. Residents in the building work different shifts and need their sleep day or night.

Unreasonable noise heard outside your apartment is a breach of the Owners Corporation rules.

Be aware of balcony noise. The proximity of balconies to bedrooms can sometimes be a lot closer than you are aware of. Always be respectful of your location and keep noise levels down.

Do not leave trash on your balcony (including cigarette butts). Always take these inside. They are dangerous and dirty—whether you are a smoker or not.



Christmas & New Years Eve Celebrations



An email will soon be sent to all our residents regarding the requirements for Christmas and New Year's Eve Celebrations.

Whilst there will be no fireworks in the CBD, we anticipate a lot of movement around the area and will be requesting notification of any parties at Eureka Tower. Stay Tuned.

Nearby Venues and Outdoor Dining

The Melbourne City Council is in the process of regenerating the City and Southbank areas with many businesses offered a helping hand for their outdoor dining spaces. The BBC and Bond Store are our closest venues utilizing this assistance.

As a result, the roads are a little narrower and there could be more foot traffic. Please be careful as you drive to get in and out of the car park. Check out Riverside Quay and along the river, lots of venues opening in a COVID Safe environment. Taxis have been flagged once again with the City of Melbourne as a potential issue.

Noticeboard

Due to health and safety reasons, the touchscreen has been turned off. Please visit the Eureka Living website to see any ads on the resident's notice board.

Please email concierge if you want anything added to the EurekaLiving website.

Pedestrians / Cyclists in the Car Park

For car park safety, please use the pedestrian crossings in the car park at all times.

Entry and exit of the car park on foot or bicycle, should be via the pedestrian crossings, otherwise car park security activation will be triggered.

This will facilitate more accurate security monitoring.

Goods Lift Bookings

It is concerning how many people do not book the goods lift for moving their items, then believe it is OK to abuse the loading dock staff when they cannot fit them in. **Its not on.** If you don't book the goods lift, don't expect to get the goods when you want it.

Treat our staff with courtesy at all times. They are there to help and do their job. Its up to you to make the booking and ensure your delivery person has a **COVID Safe Plan**. Otherwise, they will NOT be permitted on site.